

Tridel  
**home+**<sup>TM</sup>

**TRIDEL**<sup>®</sup>  
BUILT FOR LIFE



# HULLMARK CENTRE PERSONAL SELECTIONS GUIDE

# HULLMARK CENTRE

## EXPRESS YOURSELF

Welcome to the next stage of your new home journey – your Design & Décor appointment! Now begins the exciting time when you will make the decisions that will transform your new condominium into your new home. At every stage of this journey, your Customer Care team is here to assist you.

Our Customer Care Décor Representatives are knowledgeable on all Tridel products and services. We encourage you to share all of the plans you have for your new home with us so we can tailor the right features and finishes to you and your family.

Our most important goal is to help you make the selections that you will love to live with for years to come. Thank you for letting us be a part of your exciting journey. Thank you for choosing Tridel.

---

The Personal Selections Investment Guide has been created to assist you with your décor selection process and to help you establish your design preferences. The finishes and features included in this publication are generally representative of the types of features and finishes that may be available as Included and / or Personal Selections for your new Tridel home. While the majority of photography is of actual Tridel homes, please note that the accessories, furniture, lighting, wall coverings and area rugs displayed in the images are for illustration purposes only. All suites are sold un-accessorized and unfurnished.

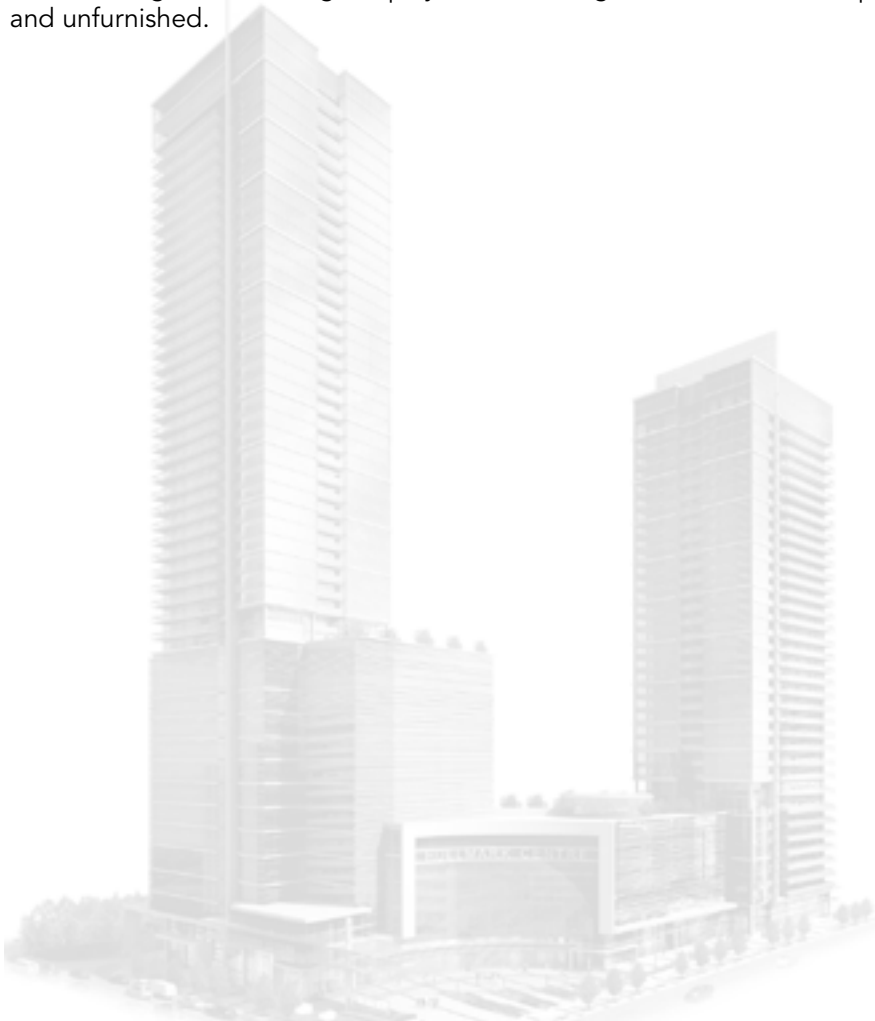

### **Hullmark Customer Care**

If you have questions about the Personal Selections Investment Guide or your Lifestyle & Design appointment, please contact your Hullmark Customer Care Décor Representative at 416.645.8793 or via email at [hullmarkcentrecc@tridel.com](mailto:hullmarkcentrecc@tridel.com).

All selections to be made from Vendor's samples. Vendor cannot guarantee colour consistency for interior finishes due to variations in dye lots and natural materials (e.g. stone and wood). Personal Selections may affect suite readiness at occupancy; please refer to the Finishes, Appliances and Extras section of your Agreement of Purchase and Sales or see your Customer Care Representative for details. Due to constantly changing material costs and labour, prices are subject to change without notice. All pricing includes any applicable credits. Tridel, Tridel Built for Life and Home + are registered trademarks of Tridel Corporation. E. & O.E., November 2011.

# PERSONAL SELECTIONS INVESTMENT GUIDE

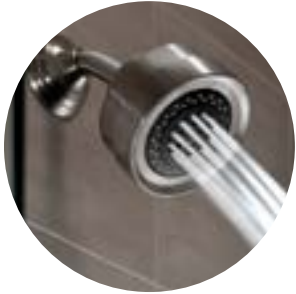

To make sure you get the most out of your Design & Décor appointment and investment with Tridel, we have provided you with this convenient Personal Selections Investment Guide so you can create a general budget that will help you plan ahead.

When you've invested in a new home you need to make sure every inch works for you and that it reflects your personal style. Tridel's Lifestyle & Design program provides you with a wide range of Included Features that are all available to you as part of your original investment. We also have Personal Selections to offer you at an additional cost that allow you to express your own distinctive vision for your new home.

These designer recommended Personal Selections have been created by the Tridel professional interior design team and reflect current market trends and customer popularity at other Tridel communities. We also understand that you may have unique ideas that require custom pricing. All this and more will be covered during your visit to our Lifestyle & Design Studio.



Personalizing your home with Tridel should be effortless and with our professional staff and experience, it can be. Superior workmanship of all your selections is ensured by regular quality control reviews throughout the construction process and the trade partnerships we have established over yours. With our award winning Customer Care Team and our outstanding Warranty program backed by TARION, you can rest assured choosing to invest in your new home through Tridel is the right decision.

## HOW TO USE THIS GUIDE:

Since there are literally hundreds of Personal Selections in our Studio for you to choose from, we have summarized this guide to reflect all available suite designs (i.e. 1 Bedroom to 2 Bedroom designs). The price ranges are estimates for the purposes of creating your initial design budget that will give you an idea on how to best prioritize your plans for customization. Detailed pricing will be provided during your appointment where you will have many pre-priced Personal Selections to choose from and for more specialized requests, we would be happy to custom price selections for you.



**Environmentally Friendly** Selection is considered an environmentally friendly alternative. Please see your Customer Care Representative for more information.







**Extra Customer Care** Selection may require additional maintenance, depending on your lifestyle or the nature of the material. Your Customer Care Representative would be happy to review proper care for these Personal Choice selections with you.





# Kitchen Selections

The kitchen is the place where all the good conversations take place and where we gather with our friends and family. With today's open concept homes, your kitchen isn't just the emotional centre of your new home; it's the heart of your style. Whether you want a kitchen with the clean, industrial lines of a modern style statement or the welcoming warmth of wooden look cabinetry, your Customer Care Décor Representative will help you realize your vision.

 Backsplash - marble mosaic or glass	\$850 - \$2,725
  Personal Selection - granite or quartz kitchen countertop including backsplash slab	\$1,020 - \$1,750
 Kitchen Faucet - in chrome or stainless steel finish	\$590 - \$810
Cabinet with 2 Recycling Bins (subject to suite design)	\$730 - \$845
Personal Selection Cabinetry (high gloss or euro laminate finish)	\$2,300 - \$8,020
Softclose Feature - applies to all cabinet doors & drawers in the kitchen	\$1,100







# Electrical Selections

Good design is based on the balance of style and function. By planning ahead for details, your enjoyment of your home will be ensured. Remember to consider the small things such as task lighting, the placement of your television and other details that will make a large impact to your comfort and enjoyment of your home later.

 *Master Switch	\$1,080
*3 Way Switch	\$320
*Convert Existing Cable or Telephone Outlet into a Multiport (cost per item)	\$180
*Relocation of any one of the following items - light switch, cable outlet, telephone outlet, multiport or duplex receptacle within the original room (cost per item)	\$130
*Relocation of Capped Ceiling Outlet	\$230
*Additional Capped Ceiling Outlet	\$220 - \$460
*Additional Duplex Receptacle	\$190 - \$300
*Additional Telephone or Cable Outlet (cost per item)	\$285
*Additional Multiport Outlet (cost per item)	\$305
Electrical Outlets with Coordinated Coverplates for Kitchen Backsplash	\$140
*Pricing before concrete	

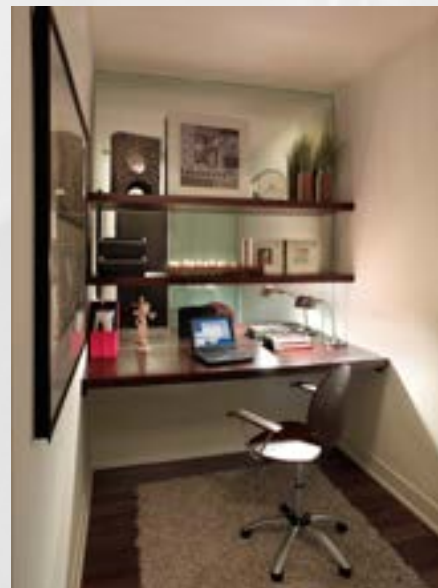







# Bedroom Selections

Don't overlook your bedroom. As the most personal room in your new home, your bedroom should be a place where you can feel relaxed and comfortable. Choose colours and textures that soothe you. Consider adding closet organizers to eliminate clutter. This is not just where you sleep; it's where you take refuge.

		Engineered Hardwood for Typical Suites - varies according to bedroom(s) sizes	\$900 - \$2,500
		Hardwood for Signature & Penthouse Suites - varies according to bedroom(s) sizes	\$1,000 - \$4,500
		Closet Organizer system with various options	\$250 - \$1,150
		Closet Frameless Mirrored Sliding Doors from White Sliding Doors	\$365 - \$680
		Closet Frosted Glass Sliding Doors from White Sliding Doors	\$650 - \$1,805





# Bathroom Selections

Don't think only of function, think solitude. Your bathroom should be a retreat from everything and everyone; your home spa. Creating a space that is both stylish and relaxing can be as easy as adding a handheld shower head that massages as it cleanses. In today's busy world, we all deserve a private space where we can withdraw from the world and rejuvenate.

Shaker Style Frosted Glass Panel Door at Bathroom Entry	\$850 - \$1,090
---	-----------------

Grab Bars - in chrome finish	\$220 - \$480
------------------------------	---------------



Faucets - Lavatory & Shower Set - in chrome or stainless steel finish	\$405 - \$2,150
---	-----------------



Handheld Shower System - in chrome or stainless steel finish	\$485 - \$3,400
--	-----------------



Dual Flush Comfort Height Toilet	\$225
----------------------------------	-------

Ceiling Tiles for Shower / Bathtub from included selections	\$640 - \$1,000
---	-----------------

Conversion from Bathtub to Frameless Shower (Typical Suites Only)	\$3,530 - \$4,500
---	-------------------

Whirlpool bathtub with Jets (Typical Suites Only)	\$2,855
---	---------







# Finishing Touches

Don't forget the details, they make all the difference. From cornice molding to paint colour, the hardware for your kitchen cabinets to your closet sliders, finishing touches are like the jewelry you wear that take your style to the next level.



Personal Selection Paint - varies according to number of room(s)	\$350 - \$1,200
--	-----------------

Cornice moulding 6" in foyer, living/dining room and den (if applicable)	\$1,250 - \$4,500
--	-------------------

Cornice moulding 7" in foyer, living/dining room and den (if applicable)	\$1,400 - \$5,000
--	-------------------

Surface-Mounted Remote Operated Electric Fireplace pricing before concrete	Starting from \$3,040
--	-----------------------



Alternate Flooring Selections for Typical Suites - engineered hardwood in lieu of included laminate flooring in foyer, living / dining room, kitchen and den (if applicable)	\$3,000 - \$4,500
--	-------------------

Alternate Flooring Selections for Signature & Penthouse Suites	\$2,000 - \$10,000
--	--------------------

Plaster Smooth Ceilings in lieu of included Stippled Ceiling (subject to locations)	\$2,000 - \$5,000
---	-------------------



# HULLMARK CENTRE

Tridel Interior Design Recommendations for Personal Selections - 1 Bedroom plus Den

**TRIDEL®**  
BUILT FOR LIFE

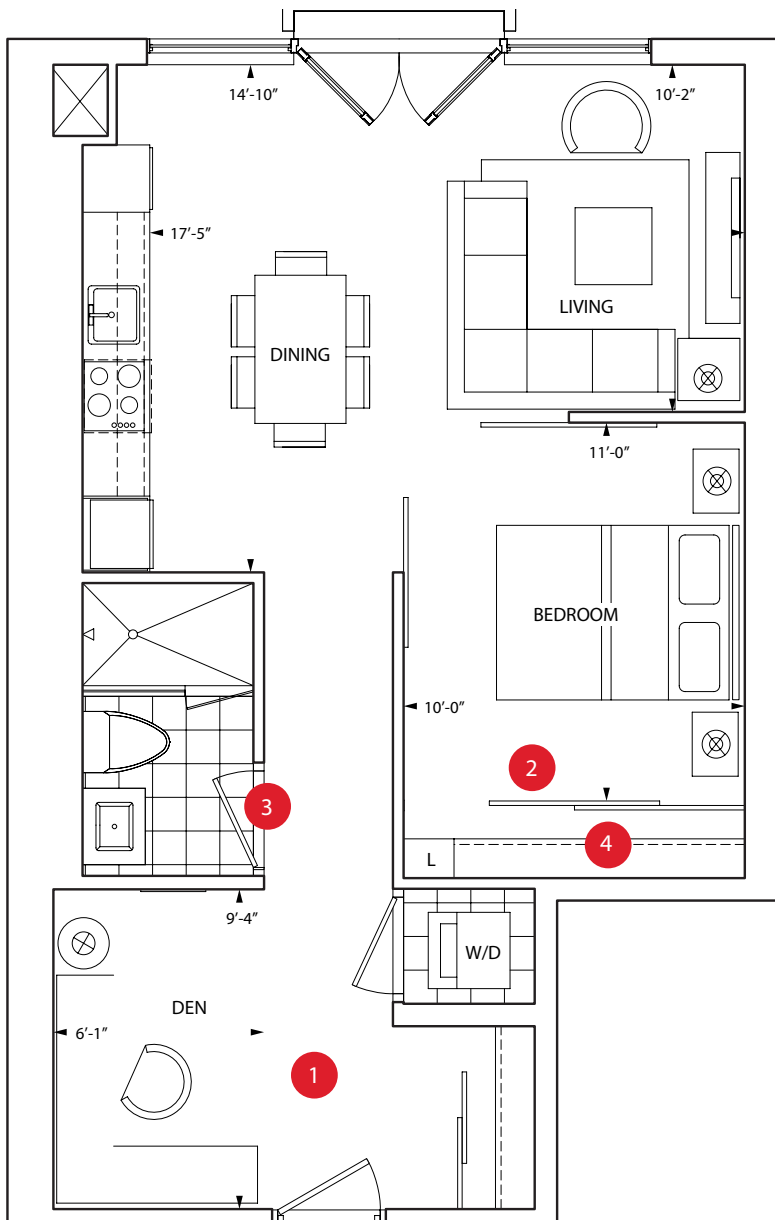

## 1 Closing Off your Den

Consider creating a more intimate atmosphere for your den by enclosing your space. Whether you work from home or just require a separate space, installing a doorway is the simplest design option. French doors offer a more traditional look while glass doors will offer light and maintain a more open feeling.



## 2 Frameless Mirrored Sliders

Mirrors double our view, adding space to your home. By eliminating the frames of traditional mirrored sliding doors, uninterrupted lines of frameless sliders add a feeling of lightness and maintain your sense of space.



## 3 Frosted Glass Bathroom Door

Transform your washroom into a spa-like retreat. Selecting a frosted glass door lends sophistication to both your Bedroom and Washroom. Light filtering through offers an open and airy feeling to your washroom while preserving your privacy.



## 4 Closet Organizers

Make every inch of your home work for you. Creating precious storage space is always a welcome idea and organizing your closets makes it easier to find what you want and save you precious time.



The finishes and features displayed are generally representative of the types of features and finishes that may be available as included and / or Personal Selections for your new Tridel home. These selections and the suppliers who provide them may vary for each Tridel Community. All suites are sold unaccessorized and unfurnished. Materials, specifications, floor plans and dimensions are subject to change without notice.

\* Tridel and Built for Life are registered trademarks of Tridel Corporation. E. & O.E. November, 2011



# HULLMARK CENTRE

Tridel Interior Design Recommendations for Personal Selections - 2 Bedroom

**TRIDEL®**  
BUILT FOR LIFE

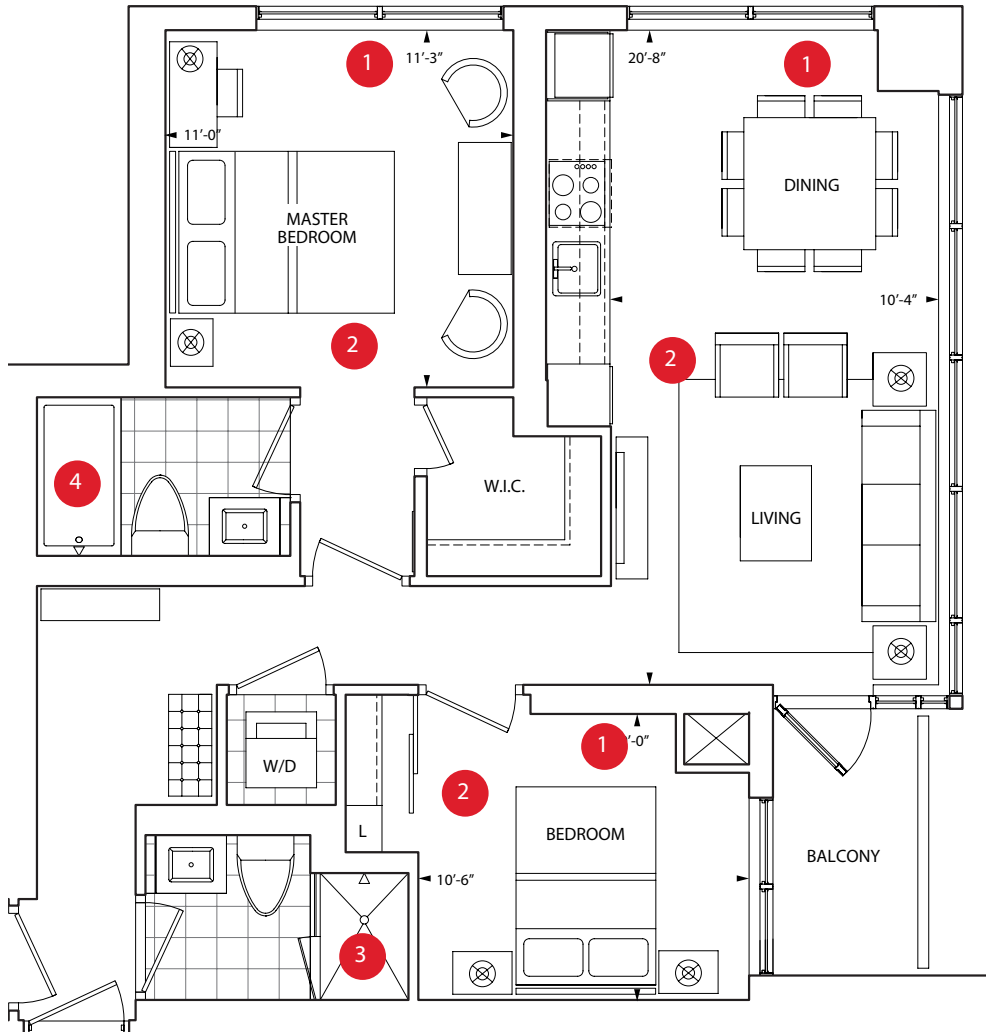

## 1 Cornice Moulding

It's the finishing touches that can make all the difference. A classically inspired architectural detail, cornice molding creates a seamless transition between your walls and ceiling.



## 2 Smooth Ceiling

A design touch that makes an immediate impact. The clean, smooth lines of this architectural feature add an element of elegance to your living spaces. For those who wish their home to have a more traditional feel, a smooth ceiling should definitely be considered.



## 4 Convert Bathtub to Shower

Virtually weightless and elegant, a shower stall can be an appealing alternative to the included bathtub.



## 3 Handheld Shower

A truly luxurious bathroom should be personalized to you. A handheld shower addition in your washroom can make a difference in your morning routine and add that little touch of indulgence to your day. On the more practical side, it can also help with maintaining the cleanliness of your shower stall or bathtub.

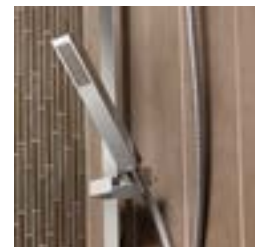

The finishes and features displayed are generally representative of the types of features and finishes that may be available as included and / or Personal Selections for your new Tridel home. These selections and the suppliers who provide them may vary for each Tridel Community. All suites are sold un-accessorized and unfurnished. Materials, specifications, floor plans and dimensions are subject to change without notice.

\* Tridel and Built for Life are registered trademarks of Tridel Corporation. E. & O.E. November, 2011

**Hullmark Centre Lifestyle & Design Studio**  
**Tel: 416-645-8793 / Email: [hullmarkcentrecc@tridel.com](mailto:hullmarkcentrecc@tridel.com)**

**[tridel.com](http://tridel.com)**